

HFS28

DUAL SOLID STATE RELAY



File No.:E133481



File No.:R50132698



File No.:CQC08001023770



Features

- Dual AC output relay
- Dielectric strength 4000V
- SCR output
- Faston terminal relay
- Environmental friendly product (RoHS compliant)

INPUT (Ta = 25°C)

Rated input voltage	1D	4VDC to 15VDC
	2D	15VDC to 32VDC
Must operate voltage	1D	4VDC
	2D	15VDC
Control current	1D	8mA to 50 mA
	2D	6mA to 20 mA
Input resistance	1D	330 x(1±20%)Ω
	2D	2 x(1±20%)kΩ
Must release voltage		1VDC

GENERAL (Ta = 25°C)

Dielectric strength	Input to output	4000VAC,50Hz/60Hz,1min
	Input/output-base	2500VAC,50Hz/60Hz,1min
Insulation resistance (input to output)		1000MΩ (at 500VDC)
Operating temperature		-40°C to 80°C
Storage temperature		-40°C to 100°C
Unit weight		Approx. 83g

OUTPUT (Ta = 25°C)

	□D-240A25Z(P)S	□D-380A25Z(P)S	□D-240A40Z(P)S	□D-380A40Z(P)S	□D-240A50Z(P)S	□D-380A50Z(P)S
Load voltage range	48VAC to 280VAC	48VAC to 440VAC	48VAC to 280VAC	48VAC to 440VAC	48VAC to 280VAC	48VAC to 440VAC
Max. transient overvoltage	600Vpk.	800Vpk.	600Vpk.	800Vpk.	600Vpk.	800Vpk.
Load current	0.1A to 25A		0.1A to 40A		0.1A to 50A	
Max. surge current (10ms)	300		600		800	
Max. I ² t (10ms, A ² s)	450		1800		3200	
Max. output on voltage drop						1.5Vr.m.s.
Max. output on leakage current						10mA
Min. off-state dv/dt						500V/μs
Max. turn-on time						Zero-cross: 1/2 cycle+1ms; Random: 1ms
Max. turn-off time						1/2 cycle+1ms
Frequency range						47Hz to 63Hz
Min. power factor						0.5



HONGFA RELAY

ISO9001, ISO/TS16949, ISO14001, OHSAS18001, IECQ QC 080000 CERTIFIED

2010 Rev. 1.00

ORDERING INFORMATION

Type	HFS28 /	1D-	240A	40	Z	S	(XXX)
Input voltage	1D: 4VDC to 15VDC 2D: 15VDC to 32VDC						
Load voltage	240A: 48VAC to 280VAC 380A: 48VAC to 440VAC						
Load current	25: 0.1A to 25A 40: 0.1A to 40A 50: 0.1A to 50A						
Zero cross function	Z: Zero cross turn-on P: Random turn-on						
Output component	S: SCR						
Customer special code							

OUTLINE DIMENSIONS, WIRING DIAGRAM AND MOUNTING HOLES

Unit: mm

Outline Dimensions

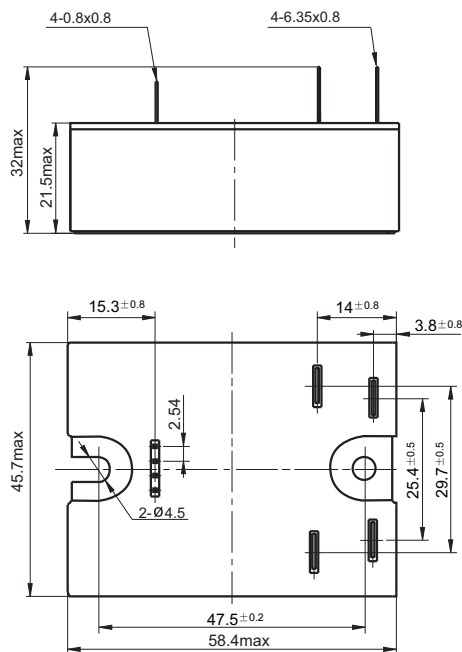

Wiring Diagram

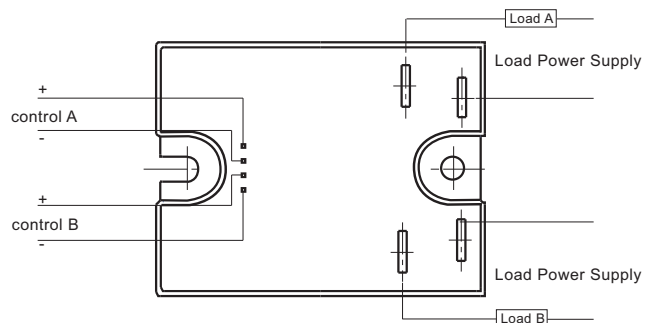

Mounting Holes Layout

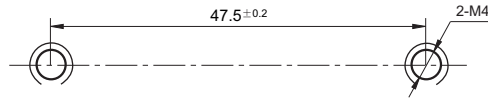

CHARACTERISTIC CURVES

Max. Load Current vs. Ambient Temp. (25A)

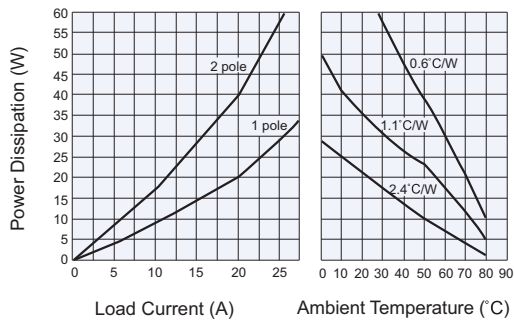

Max. Load Current vs. Ambient Temp. (40A)

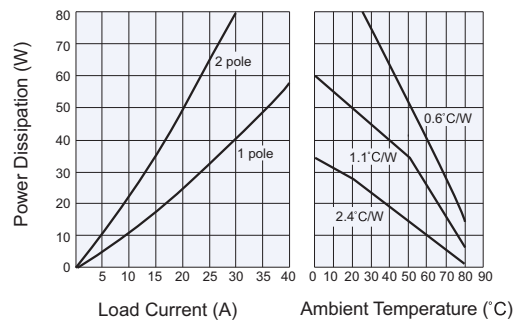

Max. Load Current vs. Ambient Temp. (50A)

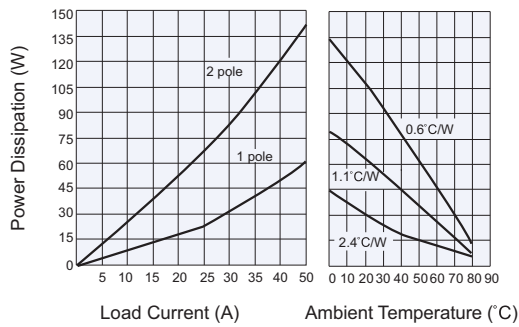

Disclaimer

This datasheet is for the customers' reference. All the specifications are subject to change without notice.

We could not evaluate all the performance and all the parameters for every possible application. Thus the user should be in a right position to choose the suitable product for their own application. If there is any query, please contact Hongfa for the technical service. However, it is the user's responsibility to determine which product should be used only.